

Centrifugally Cast Ductile Iron Pipes with Screwed / Welded Flange

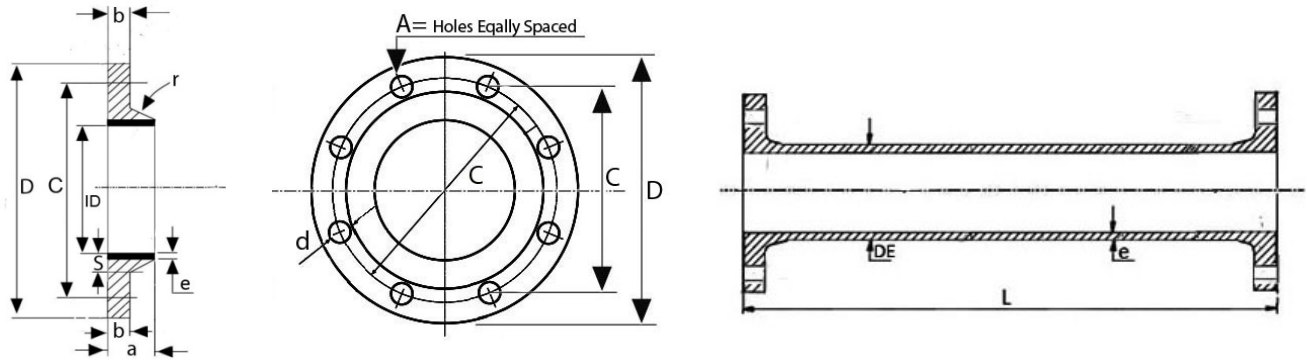

Nominal Dia.	Outside Dia.	Wall Thick.	App. Mass of One Flanges		App. Mass of Barrel/mtr.	Approx mass of One working length 'L' Including two flanges							
						PN - 10				PN - 16			
DN	DE	e	PN-10	PN-10	Non-CML	2.75M	5.0M	5.5M	6.0M	2.75M	5.0M	5.5M	6.0M
80	98	6.0	3.5	3.5	12.84	42	71	78	84	42	71	78	94
100	118	6.0	3.8	3.8	15.66	51	86	94	102	51	86	94	102
125	144	6.0	4.7	4.7	20.00	64	109	119	129	64	109	119	129
150	170	6.0	5.8	5.8	23.07	75	127	138	150	75	127	138	150
200	222	6.3	8.0	8.0	31.95	104	176	192	208	104	176	192	208
250	274	6.8	11.0	12.0	42.8	140	236	257	279	142	238	259	281
300	326	7.2	15.0	16.0	54.19	179	301	328	355	181	303	330	357
350	378	7.7	18.0	23.0	67.43	221	373	407	441	231	383	417	451
400	429	8.1	19.0	26.0	80.80	260	442	482	523	274	456	496	537
450	480	8.6	22.0	34.0	95.57	306	520	568	616	330	544	592	640
500	532	9.0	28.0	46.0	111.98	364	616	672	728	400	652	708	764
600	635	9.9	43.0	73.0	147.78	496	829	903	977	552	885	959	1033
700	738	10.8	62.0	83.0	188.24	642	1065	1159	1253	684	1107	1201	1295
750	790	11.3	74.0	96.0	211.30	729	1205	1310	1416	773	1249	1354	1460
800	842	11.7	82.0	108	233.70	807	1333	1449	1566	859	1385	1501	1618
900	945	12.6	92.0	125	283.69	964	1602	1744	1886	1030	1668	1810	1952
1000	1048	13.5	126	178	338.49	1183	1944	2114	2283	1287	2048	2218	2387
1100	1152	14.4	158	210	367.80	1327	2155	2339	2523	1431	2259	2443	2627
1200	1255	15.3	190	270	425.80	1551	2509	2722	2935	1711	2669	2882	3095

NOTE :-

1. The method of screwing and the exact form of thread are as per our own discretion as the flanges are never removed after screwing on to the barrel of the pipes.
2. If so required the flanges may be spot welded on the back side after screwing.
3. Alternatively the flanges may be completely welded on to the barrel pipes.
4. Only weldable flanges may also be supplied to be welded on to the pipes as per site requirements
5. Puddle flanges (for wall casting) may be welded on pipes as per customer's requirements.
6. Class of Pipes – K9

IS 8329:2000 # ISO 2531:2009 # BS EN 545 # BS EN 598