

# Ductile Iron Puddle Pipes with Screwed / Welded Flange

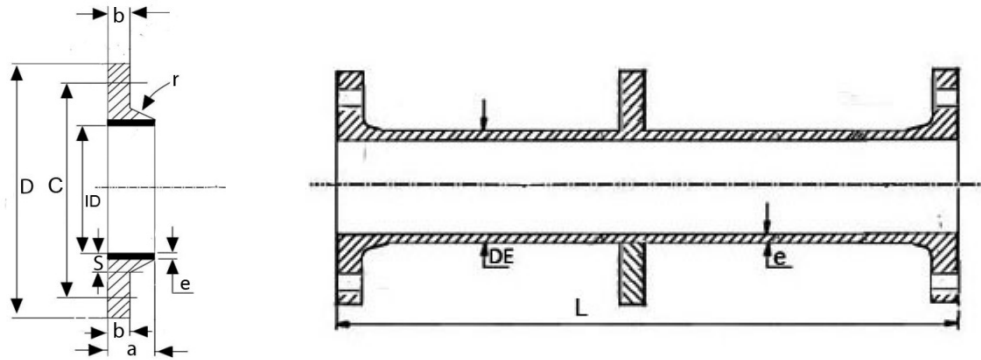

| Nominal<br>Dia. | Outside<br>Dia. | Wall<br>Thick. | App. Mass of<br>One Flanges |       | App. Mass of<br>Barrel/mtr. | Approx mass of One working length 'L' Including two flanges |        |        |         |         |         |
|-----------------|-----------------|----------------|-----------------------------|-------|-----------------------------|---|--------|--------|---------|---------|---------|
|                 |                 |                | PN-10                       | PN-16 |                             | PN - 10   |        |        | PN - 16 |         |         |
| DN              | DE              | e              |                             |       | Non-CML                     | 0.5M  | 0.75M  | 1.0M   | 0.5M    | 0.75M   | 1.0M    |
| 80              | 98              | 6.0            | 3.5                         | 3.5   | 12.84                       | 16.92   | 20.13  | 23.34  | 16.92   | 20.13   | 23.34   |
| 100             | 118             | 6.0            | 3.8                         | 3.8   | 15.66                       | 19.23   | 23.15  | 27.06  | 19.23   | 23.15   | 27.06   |
| 125             | 144             | 6.0            | 4.7                         | 4.7   | 20.00                       | 24.10   | 29.10  | 34.10  | 24.10   | 29.10   | 34.10   |
| 150             | 170             | 6.0            | 5.8                         | 5.8   | 23.07                       | 28.94   | 34.70  | 40.47  | 28.94   | 34.70   | 40.47   |
| 200             | 222             | 6.3            | 8.0                         | 8.0   | 31.95                       | 39.98   | 47.96  | 55.95  | 39.98   | 47.96   | 55.95   |
| 250             | 274             | 6.8            | 11.0                        | 12.0  | 42.8                        | 54.40   | 65.10  | 75.80  | 57.40   | 68.10   | 78.80   |
| 300             | 326             | 7.2            | 15.0                        | 16.0  | 54.19                       | 72.10   | 85.64  | 99.19  | 75.10   | 88.64   | 102.19  |
| 350             | 378             | 7.7            | 18.0                        | 23.0  | 67.43                       | 87.72   | 104.57 | 121.43 | 102.72  | 119.57  | 136.43  |
| 400             | 429             | 8.1            | 19.0                        | 26.0  | 80.80                       | 97.40   | 117.60 | 137.80 | 118.40  | 138.60  | 158.80  |
| 450             | 480             | 8.6            | 22.0                        | 34.0  | 95.57                       | 113.79  | 137.68 | 161.57 | 149.79  | 173.68  | 197.57  |
| 500             | 532             | 9.0            | 28.0                        | 46.0  | 111.98                      | 139.99  | 168.00 | 195.98 | 194.00  | 222.00  | 249.98  |
| 600             | 635             | 9.9            | 43.0                        | 73.0  | 147.78                      | 202.89  | 239.84 | 276.78 | 292.89  | 329.84  | 336.78  |
| 700             | 738             | 10.8           | 62.0                        | 83.0  | 188.24                      | 280.12  | 327.18 | 374.24 | 343.12  | 390.18  | 437.24  |
| 750             | 790             | 11.3           | 74.0                        | 96.0  | 211.30                      | 327.65  | 380.48 | 433.30 | 393.65  | 446.48  | 499.30  |
| 800             | 842             | 11.7           | 82.0                        | 108   | 233.70                      | 362.85  | 421.28 | 479.70 | 440.85  | 499.28  | 557.70  |
| 900             | 945             | 12.6           | 92.0                        | 125   | 283.69                      | 417.85  | 488.77 | 559.69 | 516.85  | 587.77  | 658.69  |
| 1000            | 1048            | 13.5           | 126                         | 178   | 338.49                      | 547.25  | 631.87 | 716.49 | 703.25  | 787.87  | 872.49  |
| 1100            | 1152            | 14.4           | 158                         | 210   | 367.80                      | 657.90  | 749.85 | 841.80 | 813.90  | 905.85  | 997.80  |
| 1200            | 1255            | 15.3           | 190                         | 270   | 425.80                      | 1111.85   | 889.35 | 995.80 | 1022.90 | 1129.35 | 1235.80 |

NOTE :-

1. The method of screwing and the exact form of thread are as per our own discretion as the flanges are never removed after screwing on to the barrel of the pipes.
2. Puddle flanges (for wall casting) may be welded on pipes as customer's requirements.
3. Class of Pipes – K9
4. Pipe Length depend on customer's requirements.

IS 8329:2000 # ISO 2531:2009 # BS EN 545 # BS EN 598